

樂信牌燃氣熱水爐

RASONIC GAS WATER HEATER

使用說明

USER INSTRUCTIONS

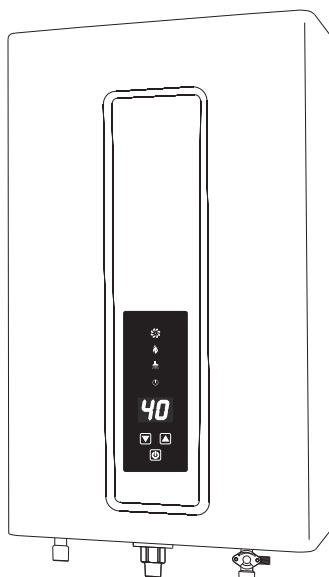

型號

RWH-N10F(T) (頂出) 香港煤氣
RWH-N10F(T) (背出) 香港煤氣
RWH-N10F(L) (頂出) 香港石油氣
RWH-N10F(L) (背出) 香港石油氣
RWH-N12F(T) (頂出) 香港煤氣
RWH-N12F(T) (背出) 香港煤氣
RWH-N12F(L) (頂出) 香港石油氣
RWH-N12F(L) (背出) 香港石油氣

MODEL

RWH-N10F(T) (TOP FLUE) HK TG
RWH-N10F(T) (BACK FLUE) HK TG
RWH-N10F(L) (TOP FLUE) HK LPG
RWH-N10F(L) (BACK FLUE) HK LPG
RWH-N12F(T) (TOP FLUE) HK TG
RWH-N12F(T) (BACK FLUE) HK TG
RWH-N12F(L) (TOP FLUE) HK LPG
RWH-N12F(L) (BACK FLUE) HK LPG

信興電工工程有限公司

SHUN HING ELECTRIC WORKS&ENGINEERING CO.LTD

由衷地感謝您選用「樂信牌」強制給排氣式熱水爐。在使用前請您詳細閱讀本說明書，正確地掌握熱水爐的安裝和使用方法，以充分利用它的優異性能。

多謝合作！

目 錄

- 警告
- 外觀結構圖及尺寸
- 主要部件及名稱
- 技術性能參數
- 使用方法及注意事項
- 日常保養須知
- 售後服務

特別警告：

本熱水爐應安裝在空氣流通良好的地方，一定要使用配套的專用對衝煙管（它將燃燒廢氣排出室外，並從室外引入新鮮空氣）。必須接好電源和接好地線方可使用。在停電或電源未接通時，請不要開啟熱水爐。如需要使用冷水時，請關閉燃氣閥門、切斷電源。請保留好說明書，以便日後查閱。

安全措施，當發覺氣體洩漏時

- 關閉氣閥。
- 打開門窗。
- 切勿開/關電源。
- 熄滅所有火種。
- 立即聯絡您的供氣商並報告洩漏。
- 此熱水爐必須由註冊氣體裝置技工負責安裝。
- 註冊氣體裝置技工必須向使用者詳細說明使用方法。
- 必須遵照此說明書內所示正確使用熱水爐，以確保熱水爐功能良好。

May we take this opportunity to thank you for purchasing this "RASONIC" balance instant gas water heater.

Before the usage, please read the instruction manual carefully, master the installation and operating method correctly, and take full advantage of the excellent performance of the water heater. Thank you for your cooperation!

CONTENTS

- Warning
- Appearance structure
- Name of main part
- Technical parameters
- Operating method & attention
- Instructions for daily maintenance
- After-sales service

SPECIAL WARNING:

The water heater should be installed in well-ventilated places, and the assorted specified balance flue must be used (it discharges exhaust gas out of the room and leads in fresh air from outside into the room). Please properly connect the power and the ground wire before using it. Do not turn on the water heater when the power is cut off or before the power is on. If you need to use cold water, please shut off the gas valve and cut off the power. Please keep the instruction manual in good condition for future reference.

For safety, if you smell gas:

- Turn off the gas valve.
- Open the windows and doors.
- Do not turn on/off the power.
- Extinguish naked flames.
- Notify the concerned company for help immediately.
- The installation must be undertaken by registered gas installers.
- The registered gas installer must specify to the user how the appliance works and how to operate it.
- Properly use the water heater complying with the instruction manual to ensure the well performance of it.

警告 WARNING

安裝爐具必須由註冊氣體裝置技工安裝，並須使用合格之喉管及配件，否則一切後果本公司及代理商概不負責。

The guarantee will be rendered invalid if the water heater is not installed by Registered Gas Installer (RGI), and approved piping and accessories must be used.

根據香港氣體安全條例，任何氣體裝置工程，包括爐具和接駁喉管的安裝，必須由註冊氣體裝置技工執行，而該技工已於相關的氣體工程類別註冊及受聘於註冊氣體工程承辦商。

According to the Gas Safety Ordinance of Hong Kong, any gas installation works including the installation of appliances and connection tubing, must be undertaken by registered gas installers who are registered for that appropriate classes and be employed by registered gas contractors.

外觀結構圖及尺寸(頂出排氣式) STRUCTURE AND DIMENSION(TOP FLUE)

RWH-N10F(T)
RWH-N10F(L)
RWH-N12F(T)
RWH-N12F(L)

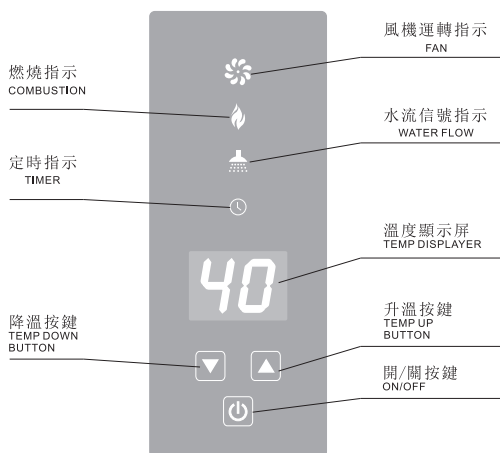
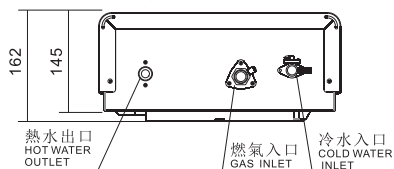
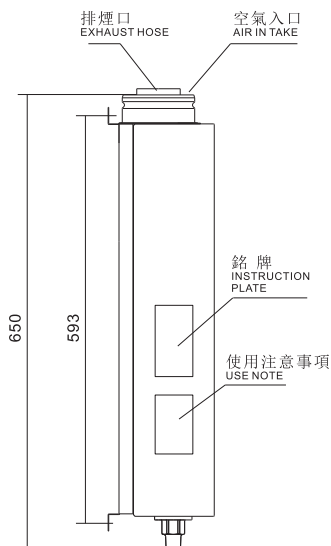
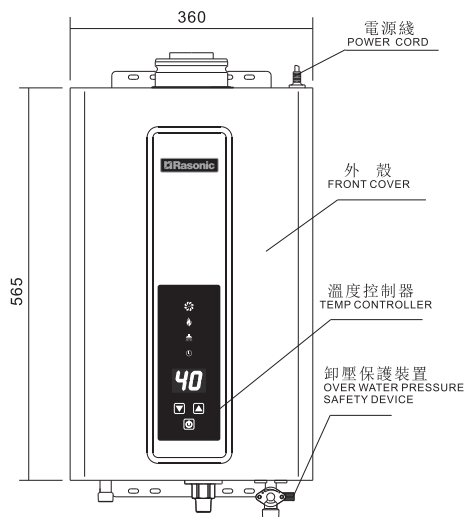

溫度控制器
TEMP CONTROLLER

主要部件及名稱(頂出排氣式) NAME OF MAIN PART(TOP FLUE)

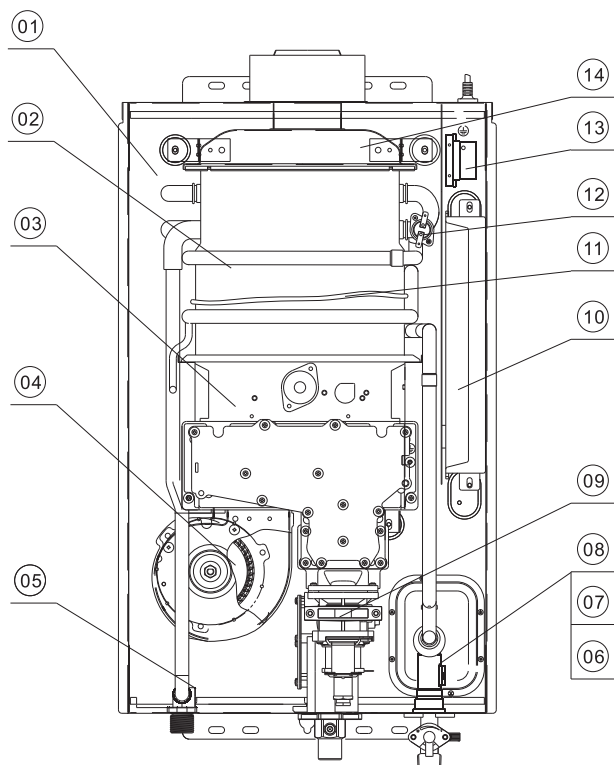

- | | |
|--------------|--|
| 01 殼體 | 01 SHELL |
| 02 熱交換器 | 02 HEAT EXCHANGER |
| 03 密封燃燒室 | 03 SEALED COMBUSTION CHAMBER |
| 04 直流風機 | 04 DC FAN |
| 05 熱水溫度傳感器 | 05 HOT WATER TEMPERATURE SENSOR |
| 06 冷水溫度傳感器 | 06 COLD WATER TEMPERATURE SENSOR |
| 07 水流量傳感器 | 07 WATER FLOW SENSOR |
| 08 水量伺服裝置 | 08 WATER VOLUME SERVO DEVICE |
| 09 燃氣比例閥 | 09 GAS PROPORTIONAL VALVE |
| 10 CPU中央控制器 | 10 CPU CENTRAL CONTROLLER |
| 11 防止燃燒室損傷裝置 | 11 COMBUSTION-CHAMBER DAMAGE PREVENTION DEVICE |
| 12 防乾燒保護裝置 | 12 ANTI-DRY BURNING PREVENTION DEVICE |
| 13 漏電保護器 | 13 LEAKAGE PROTECTION DEVICE |
| 14 集煙罩 | 14 SMOKE COLLECTION COVER |

外觀結構圖及尺寸(背出排氣式) STRUCTURE AND DIMENSION(BACK FLUE)

RWH-N10F(T)
RWH-N10F(L)
RWH-N12F(T)
RWH-N12F(L)

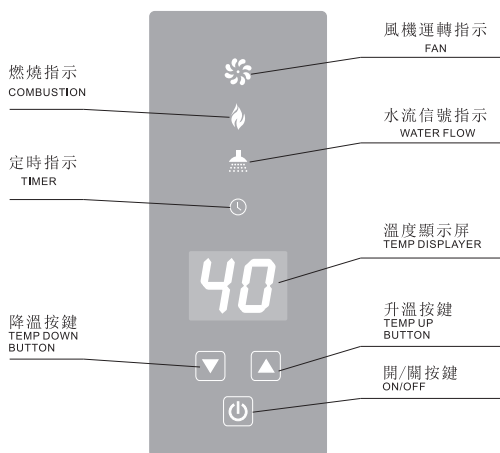
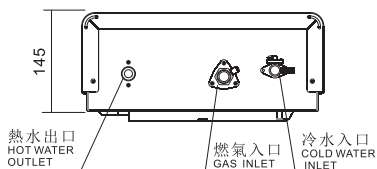
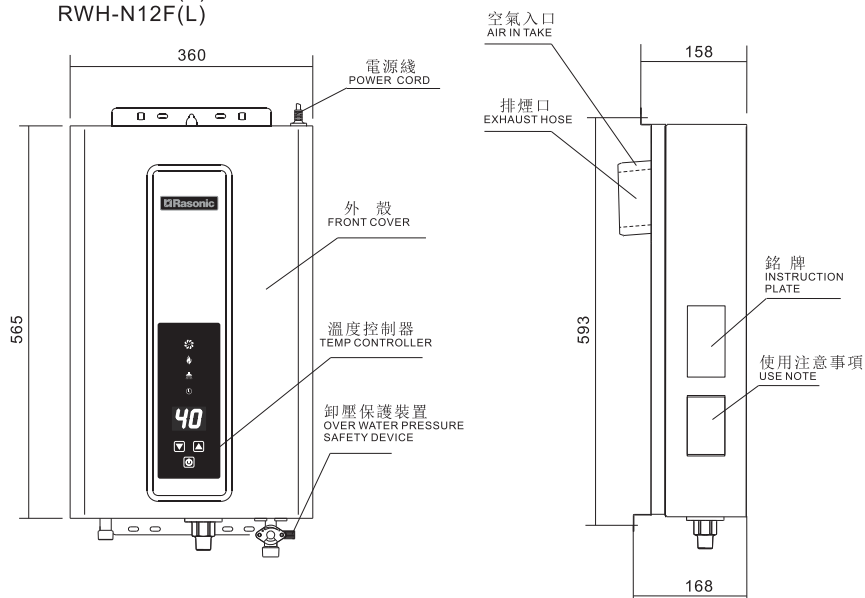

溫度控制器
TEMP CONTROLLER

主要部件及名稱(背出排氣式) NAME OF MAIN PART(BACK FLUE)

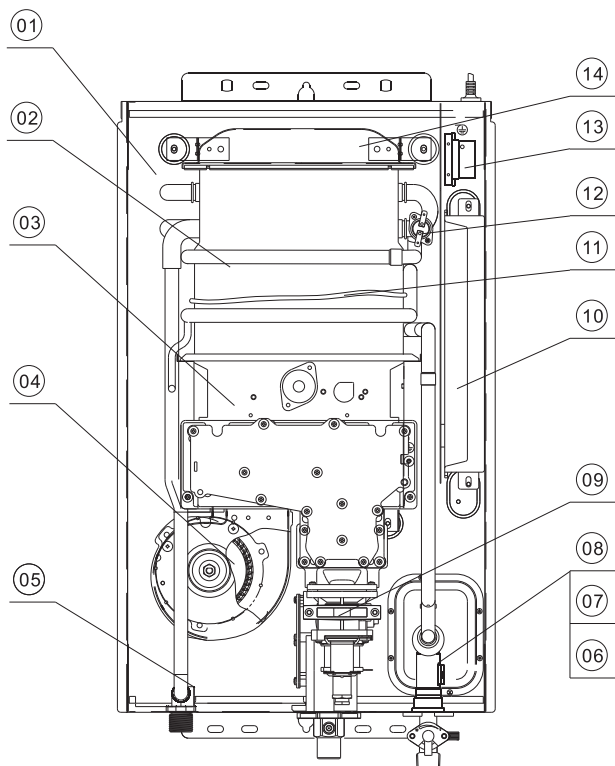

- | | |
|--------------|--|
| 01 殼體 | 01 SHELL |
| 02 熱交換器 | 02 HEAT EXCHANGER |
| 03 密封燃燒室 | 03 SEALED COMBUSTION CHAMBER |
| 04 直流風機 | 04 DC FAN |
| 05 熱水溫度傳感器 | 05 HOT WATER TEMPERATURE SENSOR |
| 06 冷水溫度傳感器 | 06 COLD WATER TEMPERATURE SENSOR |
| 07 水流量傳感器 | 07 WATER FLOW SENSOR |
| 08 水量伺服裝置 | 08 WATER VOLUME SERVO DEVICE |
| 09 燃氣比例閥 | 09 GAS PROPORTIONAL VALVE |
| 10 CPU中央控制器 | 10 CPU CENTRAL CONTROLLER |
| 11 防止燃燒室損傷裝置 | 11 COMBUSTION-CHAMBER DAMAGE PREVENTION DEVICE |
| 12 防乾燒保護裝置 | 12 ANTI-DRY BURNING PREVENTION DEVICE |
| 13 漏電保護器 | 13 LEAKAGE PROTECTION DEVICE |
| 14 集煙罩 | 14 SMOKE COLLECTION COVER |

技術性能參數

產品名稱		強制給排氣 密封燃燒室 燃氣熱水爐			
產品型號		RWH-N10F(T) RWH-N10F(L)		RWH-N12F(T) RWH-N12F(L)	
給排氣方式		頂出 強制給排氣式	背出 強制給排氣式	頂出 強制給排氣式	背出 強制給排氣式
控制方式		後制式			
點火方式		自動連續脈沖點火方式			
外形尺寸		闊360mm×高565mm×深145mm			
重 量		14. 0kg		15. 0kg	
最低啟動水壓		0. 02MPa			
最低啟動水流量		2. 5L/min			
適用工作水壓		0. 02~1. 0MPa			
產熱水能力		10升/分鐘(溫升25K)		12升/分鐘(溫升25K)	
額定熱負荷		22kW		26kW	
電 壓		AC220V 50Hz			
電功率		25W		28W	
連接 方式	冷水入口	G1/2			
	熱水出口	G1/2			
	燃氣入口	G1/2			
適用燃氣種類		香港 煤氣		香港 石油氣	
供氣壓力		1.5kPa		2.9kPa	
安全保護裝置		意外熄火安全保護裝置			
		防止燃燒室損傷安全保護裝置			
		殘火燃燒安全保護裝置			
		防燙傷安全保護裝置			
		防漏電安全保護裝置			
		防水壓過高安全保護裝置(打開: 1. 2MPa)			
		電路保險絲(5A)			

TECHNICAL PARAMETERS

NAME		FORCED AIR INTAKE & EXHAUST SEALED COMBUSTION GAS SAFETY WATER HEATER			
MODEL		RWH-N10F(T) RWH-N10F(L)		RWH-N12F(T) RWH-N12F(L)	
FLUE TYPE		FORCED AIR INTAKE & EXHAUST TOP BALANCED FLUE	FORCED AIR INTAKE & EXHAUST BACK BALANCED FLUE	FORCED AIR INTAKE & EXHAUST TOP BALANCED FLUE	FORCED AIR INTAKE & EXHAUST BACK BALANCED FLUE
CONTROL MODE		WATER FLOW CONTROLLED POST BRAKE			
IGNITION MODE		AUTO. CONTINUOUS ELECTRIC SPARKING			
DIMENSIONS		W360mm×H565mm×D145mm			
WEIGHT		14. 0kg		15. 0kg	
MINIMUM WATER PRESSURE		0. 02MPa			
MINIMUM WATER FLOW		2. 5L/min			
APPLICABLE WATER PRESSURE		0. 02-1. 0MPa			
HOT WATER SUPPLY		10L/min (Δ T =25K)		12L/min (Δ T =25K)	
RATED HEAT INPUT		22kW		26kW	
OPERATING VOLTAGE		AC220V 50Hz			
INPUT POWER		25W		28W	
CONNECTION	COLD WATER INLET	G1/2			
	HOT WATER OUTLET	G1/2			
	GAS INLET	G1/2			
GAS TYPE		HK TG		HK LPG	
GAS PRESSURE		1.5kPa		2.9kPa	
SAFETY DEVICES		FLAME FAILURE SAFETY DEVICE			
		OVERHEAT PROTECTION SAFETY DEVICE			
		HIGH LIMIT SWITCH			
		ANTI-SCALD DEVICE			
		ELECTRIC LEAKAGE PREVENTION DEVICE			
		OVER WATER PRESSURE DRAIN (ON: 1. 2MPa)			
		POWER FUSE (5A)			

使用方法及注意事項

1. 溫度控制器的使用說明：

- ① 電源開關鍵(持續按壓2-3S)；
- ② 升溫鍵,調整出熱水溫度,按下此鍵,設定溫度上升1℃；
- ③ 降溫鍵,調整出熱水溫度,按下此鍵,設定溫度下降1℃；
- ④ 設定溫度顯示屏,顯示用戶設定的溫度值；
- ⑤ 水流指示燈,打開水龍頭,此指示燈動態顯示；
- ⑥ 風機運轉指示燈,裝置風機運轉時,此燈動態顯示；
- ⑦ 燃燒指示燈,著火燃燒時,此燈點亮,否則不亮；
- ⑧ 定時功能:定時功能開放時,定時指示燈點亮,熱水器連續燃燒1小時後自動關閉。

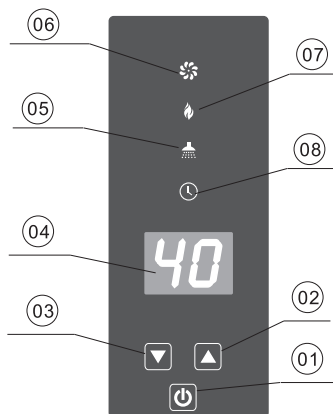

2. 溫度調節範圍：

35	36	37	38	39	40	41	42	43	44	45	46	47	48	49	50	55	60
清潔碗碟溫度				淋浴溫度				浴缸溫度				高溫					

3. 熱水爐的使用：

3.1 操作前的準備和確認

接通電源；按下操作器上之電源開關鍵；

打開燃氣氣閥；

打開出水水龍頭。

3.2 熱水爐著火與出熱水

當熱水龍頭或花灑開啟後，有水流動時，熱水爐自動點火；關水時，爐火會自動熄滅，氣閥也自動關閉。可從熱水爐溫度控制器上察看著火時「燃燒」燈是否亮起；不著火時，「燃燒」燈熄滅。當開始使用時，檢查有無亮燈，輸出熱水是否正常。

- 注意：安裝後第一次使用或長時間沒有使用熱水爐，需多次進行上述操作行為直到排出燃氣氣管路內全部空氣後才能點著火。

3.3 熱水溫度的選擇與調節

按下溫度控制器上的“升溫”“降溫”鍵，便可調節熱水溫度。從35℃-50℃，每按壓1次

OPERATING METHOD & ATTENTIONS

1. Temperature Controller Introduction:

① Power: to open and close (keep 2-3S)

② Up: to rise the outlet water temperature, 1°C up with each press

③ Down: to lower the outlet water temperature, 1°C down with each press

④ Temperature Screen: to display the set temperature value

⑤ Water-flow indicator Light: to light when the faucet is turned on

⑥ Fan Running Indicator Light: to light when the fan is running

⑦ Burning Indicator Light: to light when the fire is burning

⑧ Timing function: When the timing function is turned on, the timing indicator lights up and shuts down automatically when the water heater burns continuously for 1 hour.

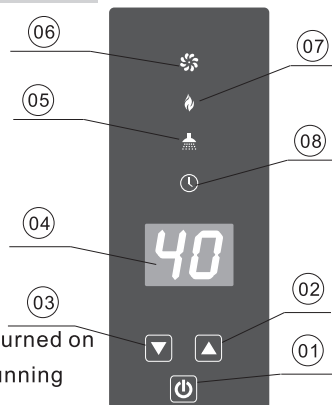

2. Range for Temperature Adjustment:

35	36	37	38	39	40	41	42	43	44	45	46	47	48	49	50	55	60
WASH TEMP				SHOWER TEMP					BATHTUB TEMP						HIGH TEMP		

3. Use of Water Heater:

3.1 Preparation and Confirmation before Operation

- 1) Connect to power supply, Press "Power" Key for opening
- 2) Turn on gas value
- 3) Turn on water faucet

3.2 Water Heater On-fire and hot-water flowing

When the hot water faucet or shower is opened, the water flows out and Water Heater is ignited automatically; when the hot water faucet or shower is closed, the water is stopped and Water Heater is closed automatically. The dynamic change can be observed by Water Heater Temperature Controller: "Burning" light is on when it is firing and "Burning" light is off when it is closed. Please check the lighting status and if the hot water is normal in the starting use.

● Remark: Please operate the above steps several times to make sure all air in the gas pipeline has been discharged so that it could be fired in the first use or re-use after long-time.

3.3 Selection and Adjustment for Hot Water

Press "Up" or "Down" key in Temperature Controller to adjust. In the range of 35°C - 50°C; 1°C is adjusted by each press;

使用方法及注意事項

升溫或降溫1℃；從50℃-60℃，每按壓1次，升溫或降溫5℃。在溫度顯示屏上，清楚顯示熱水溫度。(熱水溫度應用範圍，請按2條款的說明選擇。)

3.4 熄火及關閉熱水

當關閉熱水龍頭時,熱水爐自動熄火,內置風機將進行後清掃工作,運行數秒後停止。

當輸出熱水流量小於2.5升/分鐘時，熱水爐也會自動熄滅，關閉氣閥。

3.5 停水、停電時的處理

如遇暫時停止供水時，請關閉熱水龍頭及燃氣閥門。

如遇暫時停電時，請記住關閉熱水龍頭、燃氣閥門及電源開關。

長期不用時，請關閉燃氣閥門及電源開關。

OPERATING METHOD & ATTENTIONS

In the range of 50°C -60°C , 5°C is adjusted in each press. The set temperature of the hot water is clearly displayed in the temperature screen (For the range of hot water, please refer to the description in Point 2.)

3.4 Turn-off of Fire and Hot Water

1) When the hot-water faucet is closed, the water heater will be closed automatically. Inside fan is operating clean process and will be stopped within several minutes.

2) When the value of outlet hot water is less than 2.5L/minute, the water heater will be closed automatically and the gas value is closed

3.5 Shut-off of Water and Power Handling

1) When the water is stopped temporarily, please close the hot water faucet and gas value

2) When the power is stopped temporarily, please close the hot water faucet, gas value and power switch

使用方法及注意事項

4. 使用注意事項

4.1 預防漏氣

使用後一定要將燃氣閥門關閉。

4.2 禁止火災

禁止放置易燃物品及易揮發性物品在熱水爐周圍。

禁止放置毛巾，抹布等易燃品在排氣口和供空氣口上。

禁止開啓熱水爐後外出或睡覺。

4.3 預防燙傷

間斷使用時，要注意最初流出來的熱水溫度，以免燙傷。

使用中以及剛使用完成後，器具本身的溫度較高，所以除按鈕以外，不要用手觸摸其他部位。

4.4 事故的預防

當你嗅到燃氣臭味時，應立即將燃氣閥門關閉，打開門窗，讓燃氣排走，此時切勿開關電掣並不可打開熱水爐進出水閥門。事後一定要查明原因，並與維修部或煤氣安裝公司聯繫處理。

在使用過程中遇到中途停電或沒有接通電源，請先關閉出水閥門，待來電或接通電源後打開熱水閥門。

不得隨便打開面殼和拆卸旋鈕，以免損傷密封元件。若密封元件損壞，可以向當地特約維修站聯繫。

4.5 發生異常燃燒或其他緊急情況時的處理

萬一發生異常燃燒或其他緊急情況，不要慌張，應立即關閉燃氣閥門。

在使用過程中，萬一感覺有異常的異味時，應馬上停止使用，

及時與維修部和燃氣安裝公司聯繫處理。

OPERATING METHOD & ATTENTIONS

4. Use Notes

4.1 Leaking Prevention

Gas value must be turned off after use

4.2 Fire Prevention

1) Flammable and volatile substances are prohibited around the hot water heater

2) Towel, rags and other flammable materials are prohibited to be placed in the exhaust port and the air supply port

3) Go-out and sleeping is prohibited when the water heater is working

4.3 Scalding Prevention

1) Pay attention to the temperature of the flow-out water at the beginning in discontinuously use of the heater water

2) In use and after the completion of the use, the temperature of the heater is high. So in addition of the button, do not touch other parts of the heater

4.4 Accident Prevention

1) When you smell the gas, you should immediately turn off the gas valve; open the doors and windows to let the gas discharged. At the same time, you must not turn on the electrical switches and the water valves of the heater. Afterwards, you must find out the causes and contact with Maintenance Department or Gas Installation Company for handling.

2) If the power is stopped in the use or there is no connection to the electricity, please turn off the water values first and re-turn on the hot water value when the electricity is normally.

3) Do not open the surface shell and remove the knob in case the sealed elements are damaged. If the sealed elements are damaged, please contact with local contracted Maintenance Stations for assistance.

4.5 Handling for Abnormal Combustion and other Emergencies

1) In the face with the abnormal combustion or other emergency situation, please keep calm and turn off the gas valve immediately.

2) When you smell the abnormal odors, you must stop the use immediately and contact with Maintenance Department or Gas Installation Company for handling.

使用方法及注意事項

4.6 下列情況是正常情況，不當作故障處理

最低使用水壓

該熱水爐是感知水流量大小來確定開關燃氣閥門的，當水壓低於最低動作水壓時，水流量低於2.5L/min，系統不打開燃氣閥門。這屬於正常現象。

熱水出現白濁現象

若看見熱水出來後呈白濁現象，一會兒就變透明，這是由於溶進水中的空氣加熱後增壓而放水時急速減壓而出現小氣泡所致。

4.7 不得使用供應飲用水

由於熱水爐內長期有積水，所以本熱水爐所供應的熱水不能作為飲用水，只能作一般衛生用水。

4.8 使用硬水時

使用硬水時，熱水會在器具內形成水垢，從而增加水流阻力，損害該熱水爐性能，降低熱效率。為減少水垢，使用時可按下面方法處理：用完熱水爐後，關閉燃氣閥，讓熱水爐內的熱水全部流出來，待供熱水龍頭流出冷水後，關閉冷水龍頭。

4.9 預防漏水

在使用熱水爐後，一定要將供冷水閥門關閉。

4.10 本機必須使用原裝的電源線，使用本機必須可靠接地，使用 220V/50Hz 交流電源，以確保使用安全性。

OPERATING METHOD & ATTENTIONS

4.6 The following situation is normal, do not handle them as failure:

1) Minimum Water Pressure

The water heater will sense the water volume to decide if the gas valve is turned on or not. If the water pressure is lower than the minimum water pressure (The water flow is less than 2.5L/minute), the system could not turn on the gas valve. This is a normal situation.

2) Hot Water with white bubbles

If you see the water is clouding phenomena and becomes transparent. They are the small bubbles caused by the dissolved air in the water when it is heated with pressurization and drainage rapid decompression.

4.7 Do not Use as Drinking Water

Because there is water inside the water heater all the time, the hot water supplied by the water heater can not be used as drinking water and it could only be used as a general sanitary water.

4.8 Use of Hard Water

In the use of hard water, the scale will be formed in the container, which will increase the water flow resistance to damage the heater performance and influence the thermal efficiency. In order to reduce the scale, please operate as following method: after the use of the water heater, turn off the gas valve to let the inside hot water flow out; close the cold water faucet after all hot water inside the heater flows out completely.

4.9 Water Leaking Prevention

Please turn off the cold water value after the use of the water heater

4.10 The original power cords must be used. Keep the machine connected to the reliable grounding and use 220V/50Hz AC Power Supply to ensure the safety use.

日常保養須知

- 經常注意有無漏水現象以便及時處理。
- 經常用濕布把外表面的臟物，污垢等擦淨，然後用乾布抹乾，不易清除的污物可用中性洗滌劑擦除。
- 排氣煙管各部位應保持暢通，嚴禁堵塞煙管。
- 清潔排煙管時，請切斷電源。

INSTRUCTIONS FOR DAILY MAINTENANCE

- Please regularly check if there is water leakage so as to make timely treatment.
- Please regularly clean the surface of water heater body to remove dirt or dust with wet cloth, and then dry it with dry cloth. For the dirt that is not easy to remove, please use neutral detergent to wipe it off.
- Keep each section of the exhaust pipe clear so as to ensure the smooth discharge of exhaust gas .
- Please cut off the power supply before checking the exhaust flue.

售後服務

如您所用的熱水爐有異常情況，不能正常使用時，請按「故障與處理方法」逐項進行檢查。如處理不好或仍有不明白的地方，請不要自己隨時拆開修理，應與我公司的特約維修部或我公司售後服務部聯繫。

您也可以寫信來本公司售後服務部直接聯繫，函告時請告知下述內容：

1. 產品名稱、型號
2. 出現的現象（盡量詳細些）
3. 過程

本公司將會為你做出詳盡的服務，令稱心滿意。

裝箱單

1. 熱水爐本體	1台
2. 燃氣入口軟管接頭	1個 (HK LPG)
3. 安裝膠粒	4個
4. 安裝螺釘	4個
5. 使用說明書	1本
6. 產品維修卡	1張
7. 波紋管	2條
8. 平衡煙管、不鏽鋼彎頭、吊箍	1套 (頂出式熱水爐適用)
9. 背板、背出式煙管	1套 (背出式熱水爐適用)

AFTER-SALE SERVICE

If abnormal situation occurs and the water heater cannot be used normally , please check item by item according to the section "Failure & troubleshooting" . If there is any problem cannot be handled or understood , please contact the appointed maintenance department or customer service dpartment of our company instead of taking it apart to manage it by oneself.

You can also directly contact the cusomer service department of our company by mails providing the following information:

1. Name and model of the product
2. Description for the problem (in detail)
3. The process

Our company will provide you extensive services and make you satisfied.

PACKING LIST

1.	Water heater body	1pc
2.	Gas inlet hose joint	1pc (HKLPG)
3.	Sprayer	4pcs
4.	Mounting screws	4pcs
5.	Instruction manual	1pc
6.	Product warranty card	1pc
7.	Corrugated pipe	2pcs
8.	Balance flue, stainless steel bend, hanging hoop	1set (TOP)
9.	Back plate, Back flue	1set (BACK)



總代理：安力貿易有限公司

Sole Agent: Energy Trading Co., Ltd

香港九龍彌敦道469-471號 新光商業大廈十三字樓

**Address: 13/F, Sunbeam Commercial Building,
469-471 Nathan Road, Kowloon, Hong Kong**

Tel: (852) 2300-1210

Fax: (852) 2300-1255

客戶服務熱線：（852）2667-6662

Customer Service Hotline: (852) 2667-6662

Website: www.energytrading.com.hk